

Standard profile

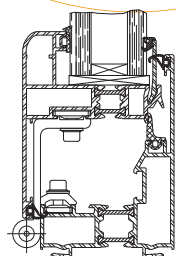

Profile with thermal bridge

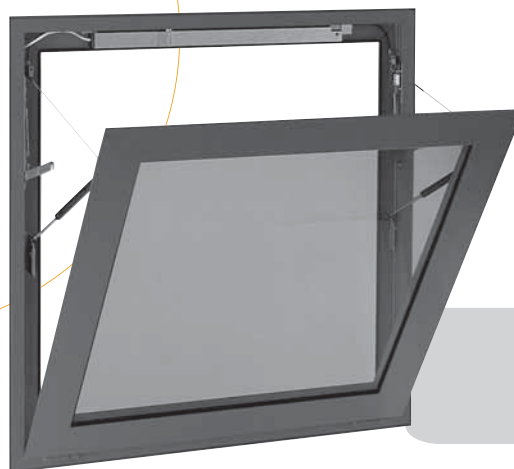

The Exubaie is a facade casement for smoke and air ventilation, equipped with components necessary for its opening.

DESCRIPTION

- Exubaie is a NSHEV (Natural Smoke and Heat Exhaust Ventilators) integrating its own mechanisms for installation on glazed structure.
- For wall installation: bottom/top/side hung outwards or inwards opening.
- The Exubaie profiles can be with or without thermal broken profile. The different adaptations available allow an easy installation on concrete, wood or on curtain wall.
- All finishes available: In any RAL paint or anodised finish.

REGULATION

- Exubaie is a NSHEV (Natural Smoke and Heat Exhaust Ventilators) conforms to EN 12101-2 and NFS 61 937-1.

PROFILES

- Standard (STD).
- Thermally broken profile (RPT).
- Adaptation on curtain wall.

PERFORMANCES

- NSHEV (Natural Smoke and Heat Exhaust Ventilators) certified NF EN 12101-2 and NFS 61 937-1.
- Classification Air/Water/wind (A 3, EE, UE) – new trials according to current European standards.
- Reliability Tests: Re 1,000 et Re 10,000.
- Aerodynamic value: Cv from 0.5 up to 0.6 in accordance with size and opening angle.
- Ug: from 1.9 up to 4 W m²/°K for opaque thermal infills.
Ug: from 2.1 up to 5.7 W m²/°K for glass infill.

* Test reports on demand.

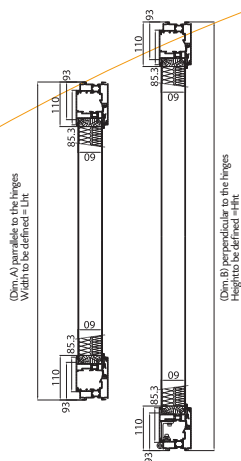

Acoustic infill

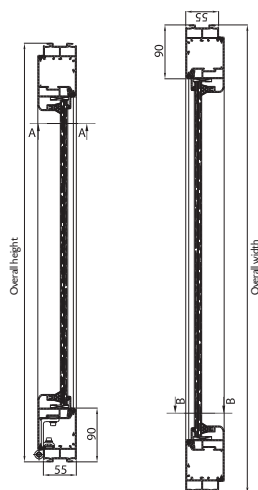

Glass infill

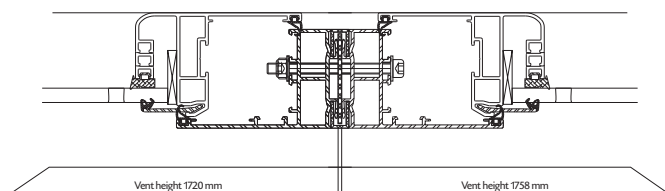

Assembly of 2 frames

DIMENSIONS

Dimensions mini and maxi, in width and length overall:

- Mini: 500 x 500
Maxi: 1,600 x 1,600 or 2,400 x 1,200
Weight of opening leaf: 60 kg maxi.
- For side hung ventilators, maximum dimensions are limited to 900 x 1,800 or 800 x 2,400
Weight of opening leaf: 60 kg.

INFILL

- Thickness mini acceptable: 6 mm with standard profile and 10 mm with thermally broken profile, Thickness maxi acceptable: 26 mm with standard profile and to 38 mm with thermally broken profile.

Filling available:

- Polycarbonate (PCA): 10 mm, 16 mm, 32 mm (light, opalescent or bronze).
- Insulated glass: standard, with reinforced insulation, with solar control...
- Thermal insulated infill: opaque, insulated aluminium (2 sheets of aluminium 15/10° + 30 mm insulation).
- Acoustic infill also available.

TYPES OF CONTROLS

- Electric.
- Pneumatic.
- Mechanic.

Remote control:

- Basic release or opening and closing.

Mode:

- Power on mode.
- Fail safe open.

OPTIONS

- Thermal releaser.
- Safety switches open/close (Security option).

INSTALLATION

- For vertical wall installation ($\pm 10^\circ$). Consult us.
- Specific adaptation profiles, accessories available.

PROJECT
CE MARK REQUIRED: YES or NO

Person concerned: _____
Date: _____

CHARACTERISTICS

F Vertical 90° *NB: If inclined please confirm _____ °*

FINISH
 P Color anodisation n° _____
 L Paint RAL standard n° _____
 A Special anodisation
 S Natural anodisation

OVERALL DIMENSIONS (width x height)
 Width (mm)
 Height (mm)

PROFILE
 STD Standard profile
 RPT Thermally broken profile
 FIX Fixed

TYPE OF OPENING
 BO Bottom hung outwards opening (width // hinges)
 TO Top hung outwards opening (width // hinges)
 SO Side hung outwards opening (width // hinges)
 BI Bottom hung inwards opening (width // hinges)
 TI Top hung inwards opening (width // hinges)
 SI Side hung inwards opening (width // hinges)
 F Fixed Exubaie, without opening

OPENING ANGLE (if a minimum one is required)
 degrees

GLAZING
 W Without glazing Type: _____ Thickness: _____ (if CE marked it is compulsory that the glazing be installed by ADEXSI)
 S Simple glass clear: _____ mm
 VL Laminated clear: _____ Thickness glazing: _____ mm
 D Double glazing clear _____ / _____ / _____ Thickness: _____
 SP Double special glass:
 A Aluminium insulated panel 30 mm painted RAL
 AP Acoustical panel 40 DB painted RAL
 Others: _____

ACTUATOR
 M Mechanical open close
 MO Mechanical open only
 EF Electrical 24 Vdc fail safe open / power to close
 EP Electrical 24 Vdc power on mode open/close
 PP Pneumatic open close fail safe
 PF Pneumatic open close

STANDARD ADAPTATION
 PS Predrilled and vis
 PSW Position contact OPEN
 CLOSE

QUANTITY: _____
 SPECIAL ADAPTATION REQUIRED:

